

Important:

Please follow the instructions below to replace the left side (non-drive side) axle support cup and plastic bushing on your Nashbar Mag Plus Trainer (NA-MAGP) or Nashbar Fluid Trainer (NB-FT6). You can view a short video clip of the procedure here: <http://www.nashbar.com/help/trainerrecallvideo.cfm>

Tools Required:

- Flat blade screwdriver
- Hammer

REPLACEMENT INSTRUCTIONS:

Step One:

The left side axle support cup (A) is attached to a plastic bushing (B) which is pressed into the trainer frame. To remove the plastic bushing, first use a screwdriver to remove the plastic cap (C) from the opposite end of the frame tube. See Figure 1.

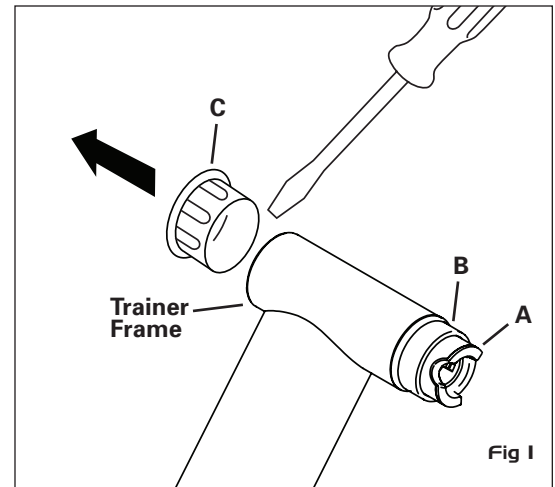

Step Two:

Insert the screwdriver handle in the frame tube and tap on the screwdriver blade with a hammer to knock out the bushing. See Figure 2.

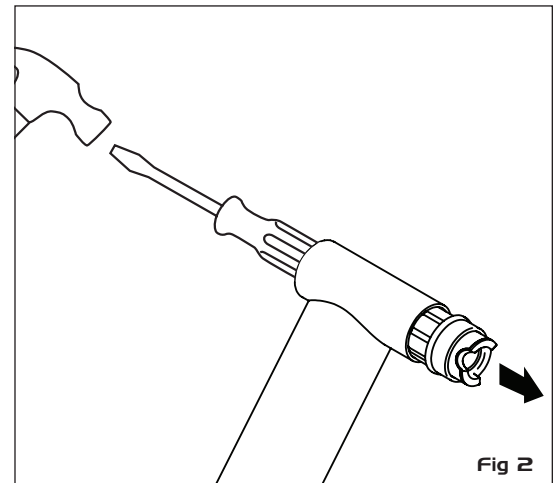

Step Three:

Install the replacement bushing and axle cup by aligning the bushing with the open frame tube and pressing the bushing into the frame tube by hand as far as it will go. See Figure 3.

Step Four:

If you're not able to fully insert the bushing by hand, tap on the metal axle cup (A) with a hammer to fully seat the bushing.

Step Five:

Reinstall the plastic cap (C) which was removed from the end of the frame tube in Step 1.

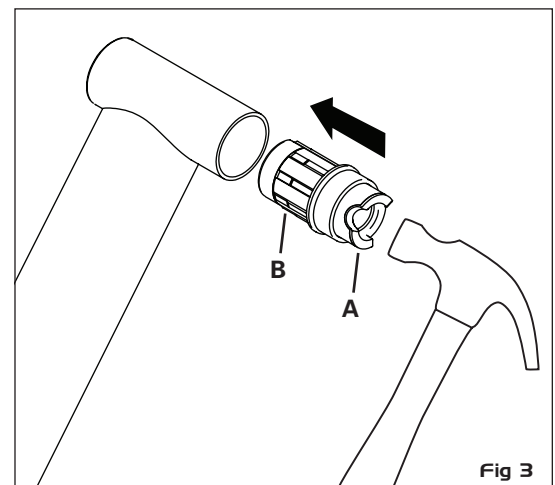

If you have any questions about which trainers are affected by this notice, or about the procedure described above, please contact Nashbar Tech Support at 1-800-888-2710